

## AECI HELDERBERG PROPERTIES CONCEPTUAL DEVELOPMENT FRAMEWORK PLAN WESTERN CAPE SOUTH AFRICA

With the closure of the explosives manufacturing plant AECI perceived an opportunity to redevelop their landholdings for the benefit of their shareholders and the local community. The framework plan aimed to achieve this by creating favourable conditions for developers and investors

HHO Africa were part of the AECI Helderberg team responsible for the conceptual development framework plan designed to motivate changes to the AECI Somerset west Structure Plan. HHO Africa held specific responsibility for the traffic and transportation aspects of the development and the impacts on the surrounding area.

Apart from the technical details dealt with during the study HHO Africa were also involved in the public participation process which formed an integral part of the planning.

Among the issues dealt with by HHO Africa were:

- ◆ *Review with the team the possible land use scenarios and the consequent implications for the optimisation of the transportation system.*
- ◆ *Review the available and possible future major access points to the various stages of the development.*
- ◆ *Examine the activity spine proposals as part of the overall transportation system*
- ◆ *Develop with the planners the on-site road pattern and its links with the important external transportation links.*
- ◆ *Collaborate with the regional (MTP) and local (Helderberg) transportation authorities on the development of the transportation proposals*

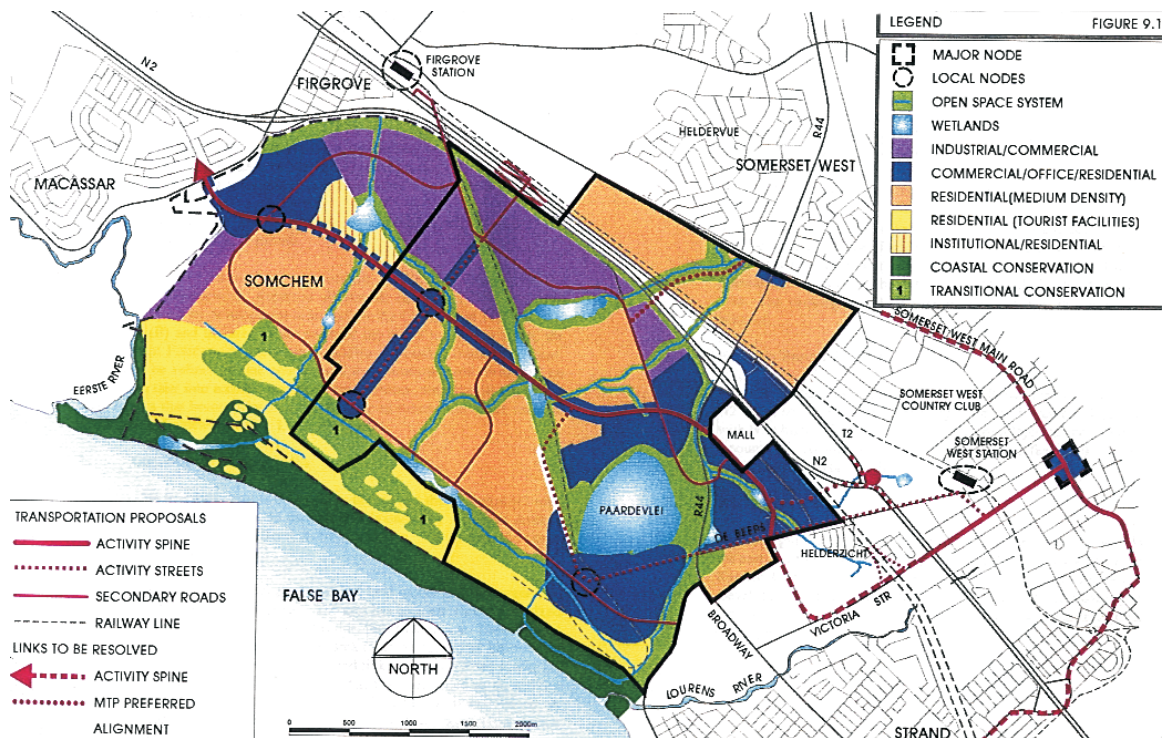

Development Framework Plan for Helderberg Basin